

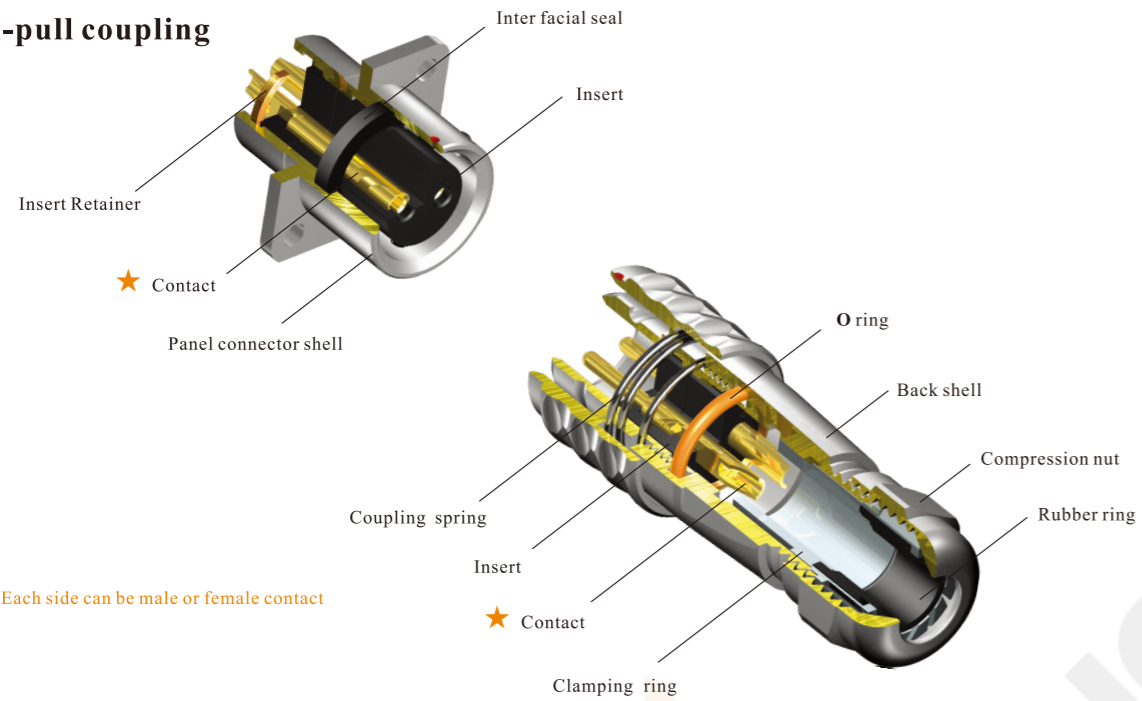

- SF Series IP67
- Push-pull coupling



Material and spec

Coupling	Push-pull	
Shell material	Brass with chrome plating	
Insert material	PPS max temperature 260 °C	
Contact material	Brass with gold plating	
Termination	Solder: SF6, SF8, SF10, SF12, SF16, SF20 Crimp: SF16, SF20 Screw: SF20 (Ø2.5mm contact)	
Cable outer diameter range	SF6: I: 2-3mm, II: 3-4mm SF8: I: 3-4mm, II: 4-5mm SF10: I: 3-4mm, II: 4-6.5mm	SF12: I: 4-6.5mm, II: 5-8mm SF16: I: 5-8mm, II: 8-12mm SF20: I: 5-9mm, II: 8-12mm
IP rating	IP67	
Mating cycle	500	
Temperature range	-40°C ~ +85°C	
Insulation resistance	2000MΩ	

SF6 Series

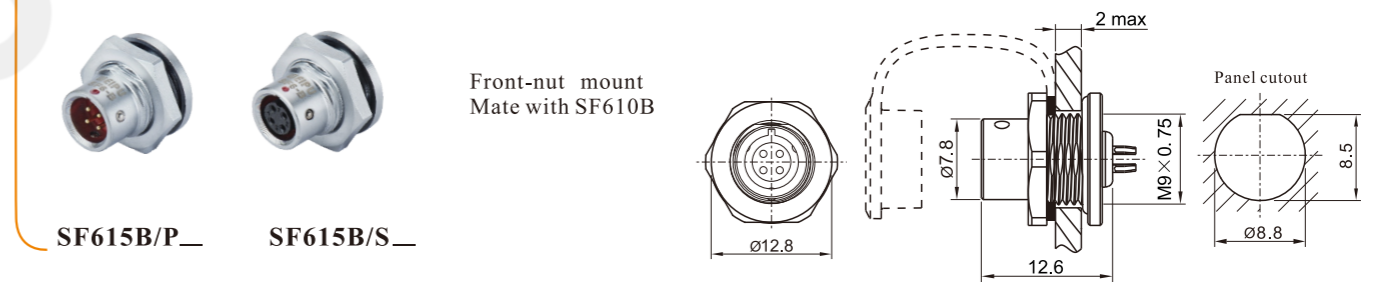
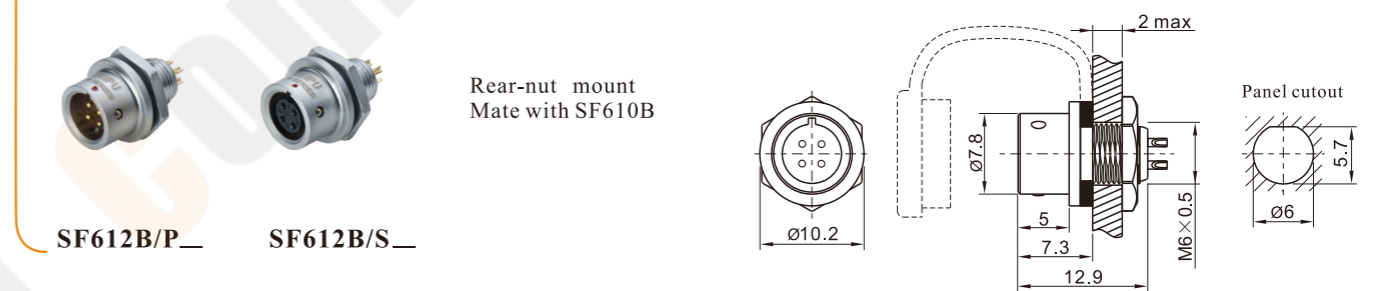
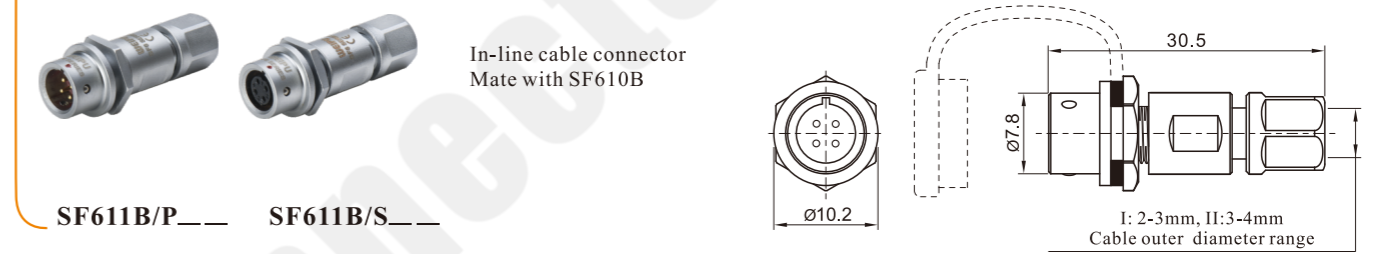

Solder contact spec

Number of contact	2	3	4	5
Male contact face view				
Rated current (A)	3	3	3	3
Contact diameter(mm)	Ø0.6×2	Ø0.6×3	Ø0.6×4	Ø0.6×5
Rated voltage (AC.V)	30	30	30	30
Test voltage(AC.V) 1 min	500	500	500	500
Contact resistance(mΩ)	10	10	10	10
Wire size(mm ² /AWG)	≤0.5/20	≤0.5/20	≤0.5/20	≤0.5/20

SF8 Series

SF
8



Cable connector
Mate with SF811B, SF812B,
SF815B

SF810B/P SF810B/S

Male contact

Cable outer diameter range
I: 3-4mm, II: 4-5mm
Number of contact
Female contact

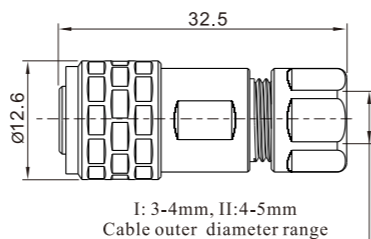
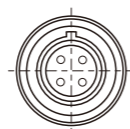

In-line cable connector
Mate with SF810B

SF811B/P SF811B/S

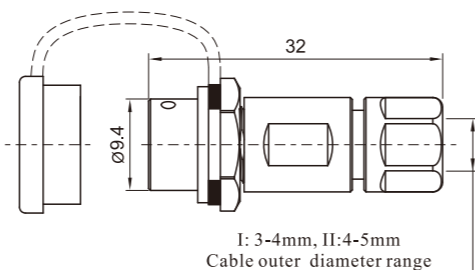
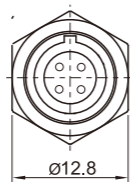

Rear-nut mount
Mate with SF810B

SF812B/P SF812B/S

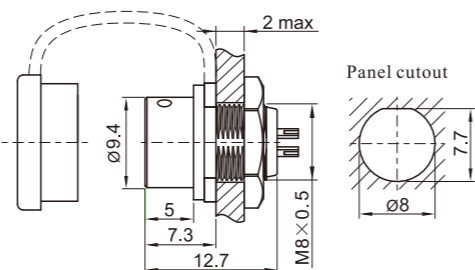
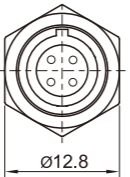

Front-nut mount
Mate with SF810B

SF815B/P SF815B/S

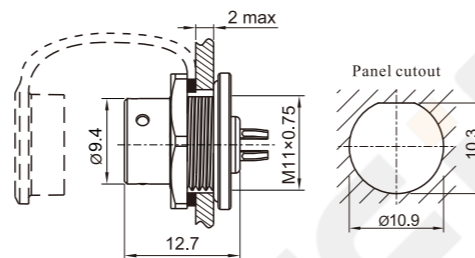
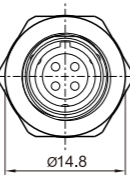

Solder contact spec

Number of contact	2	3	4	6	8
Male contact face view					
Rated current (A)	5	5	3	3	3
Contact diameter(mm)	Ø1×2	Ø1×3	Ø0.6×4	Ø0.6×6	Ø0.6×8
Rated voltage (AC.V)	125	125	30	30	30
Test voltage(AC.V) 1 min	1000	1000	500	500	500
Contact resistance(mΩ)	5	5	10	10	10
Wire size (mm ² /AWG)	≤0.75/18	≤0.75/18	≤0.5/20	≤0.5/20	≤0.5/20

SF10 Series

SF
10



Cable connector
Mate with SF1011, SF1012,
SF1015

SF1010/P SF1010/S

Male contact

Cable outer diameter range
I: 3-4mm, II: 4-6.5mm
Number of contact
Female contact

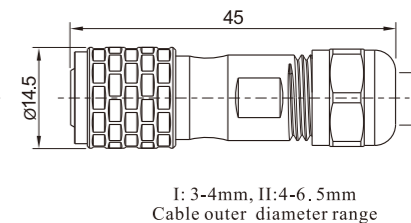
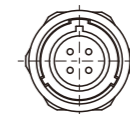

In-line cable connector
Mate with SF1010

SF1011/P SF1011/S

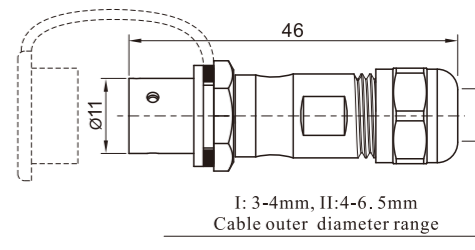
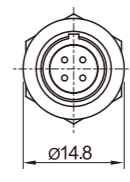

Rear-nut mount
Mate with SF1010

SF1012/P SF1012/S

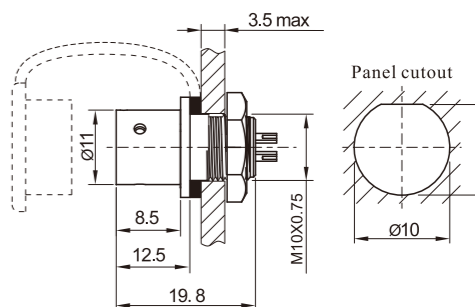
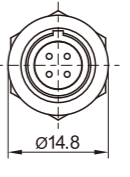

Front-nut mount
Mate with SF1010

SF1015/P SF1015/S

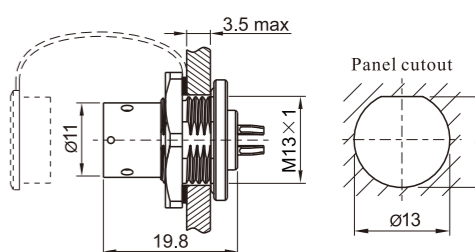
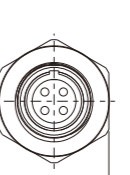

Solder contact spec

Number of contact	2	3	4	5
Male contact face view				
Rated current (A)	5	5	3	3
Contact diameter(mm)	Ø1×2	Ø1×3	Ø0.7×4	Ø0.7×5
Rated voltage (AC.V)	180	180	125	125
Test voltage(AC.V) 1 min	1000	1000	1000	1000
Contact resistance(mΩ)	5	5	10	10
Wire size (mm ² /AWG)	≤0.75/18	≤0.75/18	≤0.5/20	≤0.5/20

SF12 Series

SF
12



Cable connector
Mate with SF1211, SF1212,
SF1213, SF1215

SF1210 / P — SF1210 / S —
Male contact Female contact

Cable outer diameter
I: 4-6.5mm, II: 5-8mm
Number of contact

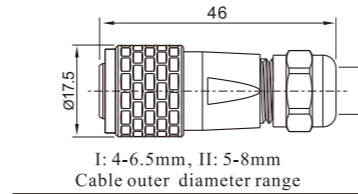
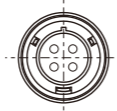

I: 4-6.5mm, II: 5-8mm
Cable outer diameter range



Angled cable connector
Mate with SF1211, SF1212, SF1213, SF1215

SF1214 / P — II SF1214 / S — II

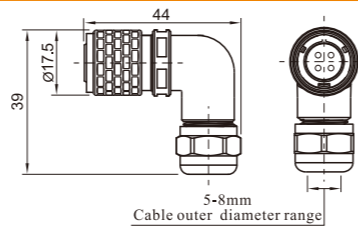

5-8mm
Cable outer diameter range



In-line cable connector
Mate with SF1210, SF1214

SF1211 / P — SF1211 / S —

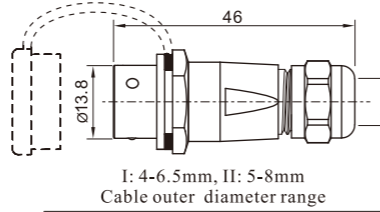

I: 4-6.5mm, II: 5-8mm
Cable outer diameter range



Rear-nut mount
Mate with SF1210,
SF1214

SF1212 / P — SF1212 / S —

Number of contact

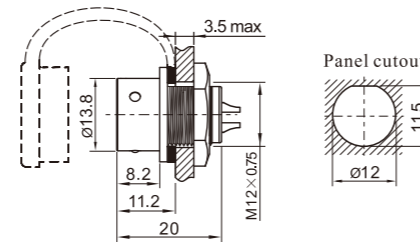
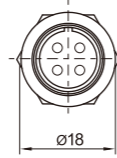

Panel cutout

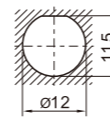

Square flange
Mate with SF1210,
SF1214

SF1213 / P — SF1213 / S —

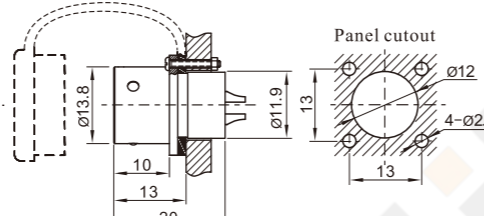
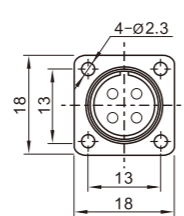

Panel cutout

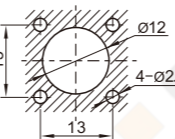

Front-nut mount
Mate with SF1210,
SF1214

SF1215 / P — SF1215 / S —

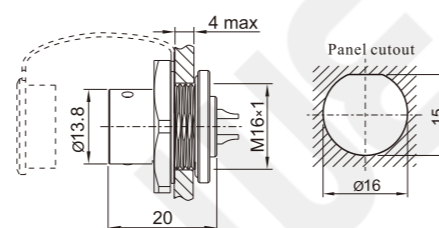

Panel cutout

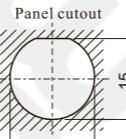

Solder contact spec

Number of contact	2	3	4	5	6	7	9
Male contact face view							
Rated current (A)	13	13	5	5	5	5	3
Contact diameter(mm)	Ø1.6X2	Ø1.6X3	Ø1X4	Ø1X5	Ø1X6	Ø1X7	Ø0.7X9
Rated voltage (AC.V)	250	250	200	180	125	125	125
Test voltage(AC.V) 1 min	1500	1500	1500	1000	1000	1000	1000
Contact resistance (mΩ)	2.5	2.5	5	5	5	5	10
Wire size (mm ² /AWG)	≤2/14	≤2/14	≤0.75/18	≤0.75/18	≤0.75/18	≤0.75/18	≤0.5/20

SF12 Series

SF
12



Cable connector
Mate with SF1211, SF1212,
SF1213

SF1210 / P — SF1210 / S —
Male contact Female contact

(U):
Number of contact

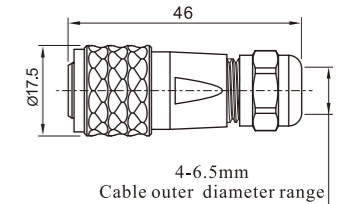
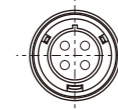

4-6.5mm
Cable outer diameter range



Angled cable connector
Mate with SF1211, SF1212, SF1213

SF1214 / P — II SF1214 / S — II

(U):

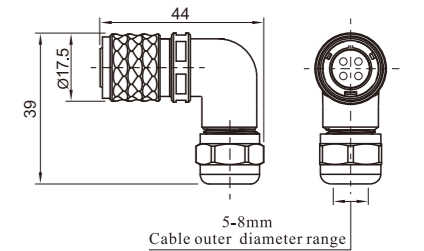

5-8mm
Cable outer diameter range



In-line cable connector
Mate with SF1210, SF1214

SF1211 / P — SF1211 / S —

(U):

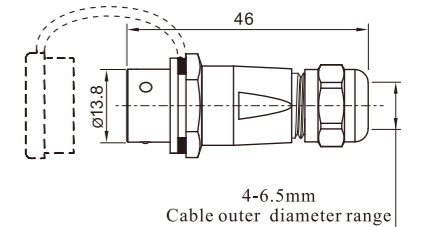
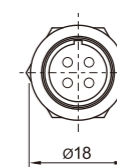

4-6.5mm
Cable outer diameter range



Rear-nut mount
Mate with SF1210,
SF1214

SF1212 / P — SF1212 / S —

(U):
Number of contact

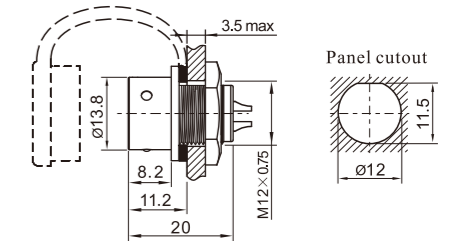
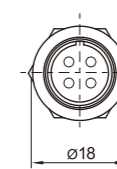

Panel cutout

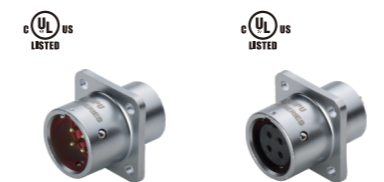
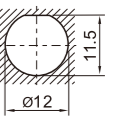

Square flange
Mate with SF1210,
SF1214

SF1213 / P — SF1213 / S —

(U):

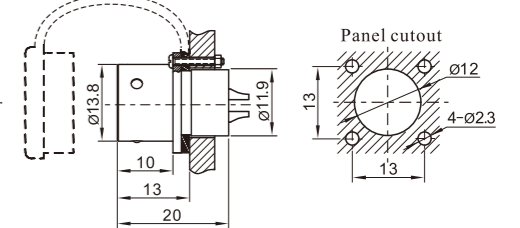
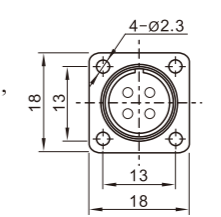

Panel cutout

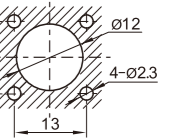

Solder contact spec

Number of contact	4	5	6	7
Male contact face view				
Rated current (A)	5	5	5	5
Contact diameter(mm)	Ø1X4	Ø1X5	Ø1X6	Ø1X7
Rated voltage (AC.V)	300	300	300	300
Test voltage(AC.V) 1 min	1500	1000	1000	1000
Contact resistance (mΩ)	5	5	5	5
Wire size (AWG)	18	18	18	18

SF16 Series

SF
16



Cable connector
Mate with SF1611, SF1612,
SF1613, SF1615

SF1610 / P --- SF1610 / S ---
Male contact

1: solder, 3: crimp
Cable outer diameter
I: 5-8mm, II: 8-12mm
Number of contact
Female contact

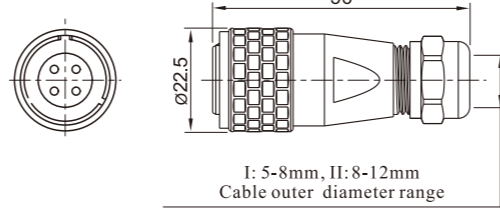

I: 5-8mm, II: 8-12mm
Cable outer diameter range



In-line cable connector
Mate with SF1610

SF1611 / P --- SF1611 / S ---

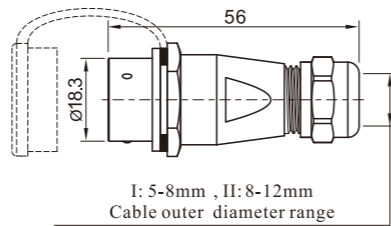

I: 5-8mm, II: 8-12mm
Cable outer diameter range



Rear-nut mount
Mate with SF1610

SF1612 / P --- SF1612 / S ---

1: solder, 3: crimp
Number of contact

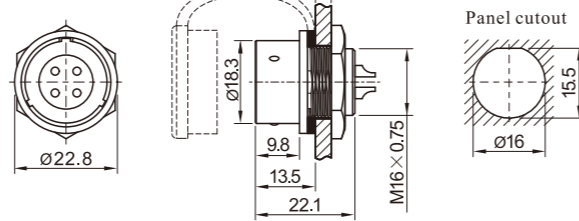

Square flange
Mate with SF1610

SF1613 / P --- SF1613 / S ---

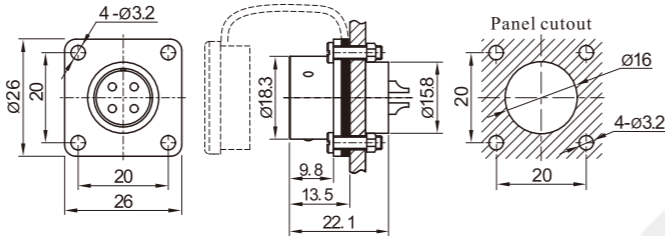

Front-nut mount
Mate with SF1610

SF1615 / P --- SF1615 / S ---

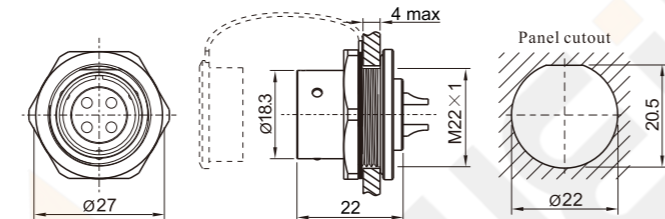

Solder contact spec

★ Crimp contact spec see P20

Number of contact	2	3	4	2B	3B	4B	5	7	9	10
Male contact face view										
Rated current (A)	10	10	5	15	15	15	5	5	5	5
Contact diameter(mm)	Ø1.5X2	Ø1.5X3	Ø1X4	Ø2X2	Ø2X3	Ø2X4	Ø1X5	Ø1X7	Ø1X9	Ø1X10
Rated voltage (AC.V)	500	500	500	500	500	500	500	400	400	400
Test voltage(AC.V) 1 min	1500	1500	1500	1500	1500	1500	1500	1200	1200	1200
Contact resistance (mΩ)	2.5	2.5	5	2.5	2.5	2.5	5	5	5	5
Wire size (mm ² /AWG)	≤2/14	≤2/14	≤0.75/18	≤2/14	≤2/14	≤2/14	≤0.75/18	≤0.75/18	≤0.75/18	≤0.75/18

SF20 Series

SF
20



Cable connector
Mate with SF2011, SF2012,
SF2013, SF2015

SF2010 / P --- SF2010 / S ---
Male contact

1: solder, 2: screw, 3: crimp
Cable outer diameter range
I: 5-9mm, II: 8-12mm
Number of contact
Female contact

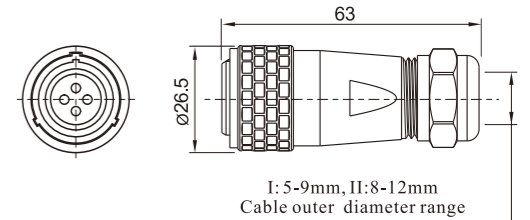

I: 5-9mm, II: 8-12mm
Cable outer diameter range



In-line cable connector
Mate with SF2010

SF2011 / P --- SF2011 / S ---

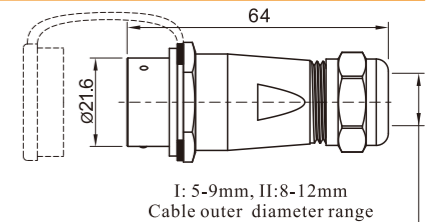

I: 5-9mm, II: 8-12mm
Cable outer diameter range



Rear-nut mount
Mate with SF2010

SF2012 / P --- SF2012 / S ---

1: solder, 2: screw, 3: crimp
Number of contact

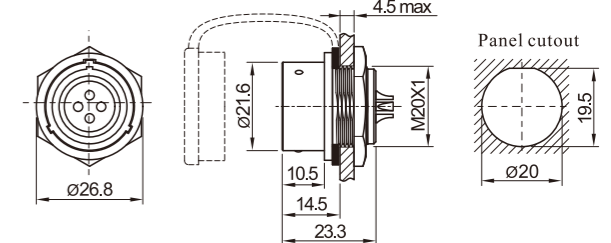

Square flange
Mate with SF2010

SF2013 / P --- SF2013 / S ---

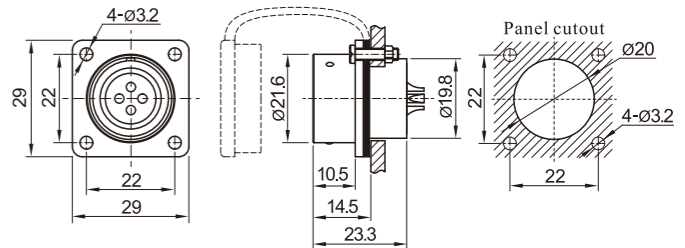

Front-nut mount
Mate with SF2010

SF2015 / P --- SF2015 / S ---

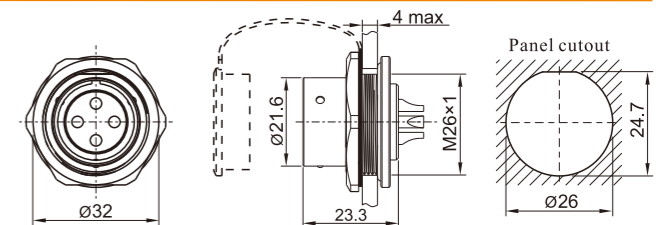

Solder contact spec

★ Crimp contact spec see P20

★ Screw contact spec see P21

Number of contact	2	3	4	5	6	6B	7	8	9	12	15
Male contact face view											
Rated current (A)	25	25	25	10	25 5	30 5	10	10	5	5	5
Contact diameter(mm)	Ø2.5X2	Ø2.5X3	Ø2.5X4	Ø1.5X5	Ø2.5X4 Ø1X2	Ø3X2 Ø1X4	Ø1.5X7	Ø1.5X8	Ø1X9	Ø1X12	Ø1X15
Rated voltage (AC.V)	500	500	500	500	500	500	500	500	400	400	400
Test voltage(AC.V) 1 min	1500	1500	1500	1500	1500	1500	1500	1500	1200	1200	1200
Contact resistance (mΩ)	1	1	1	2.5	1 5	1 5	2.5	2.5	5	5	5
Termination	solder / screw	solder / screw	solder / screw	solder	solder	solder	solder	solder	solder	solder	solder
Wire size for solder (mm ² / AWG)	≤4/11	≤4/11	≤4/11	≤2/14	≤4/11 ≤0.75/18	≤4/11 ≤0.75/18	≤2/14	≤2/14	≤0.75/18	≤0.75/18	≤0.75/18
Wire size for screw termination (mm ² / AWG)	≤1.5/15	≤1.5/15	≤1.5/15	/	/	/	/	/	/	/	/